

**1** First Floor Plan  
Scale: 1/8" = 1'-0"  
FD = FLOOR DRAIN

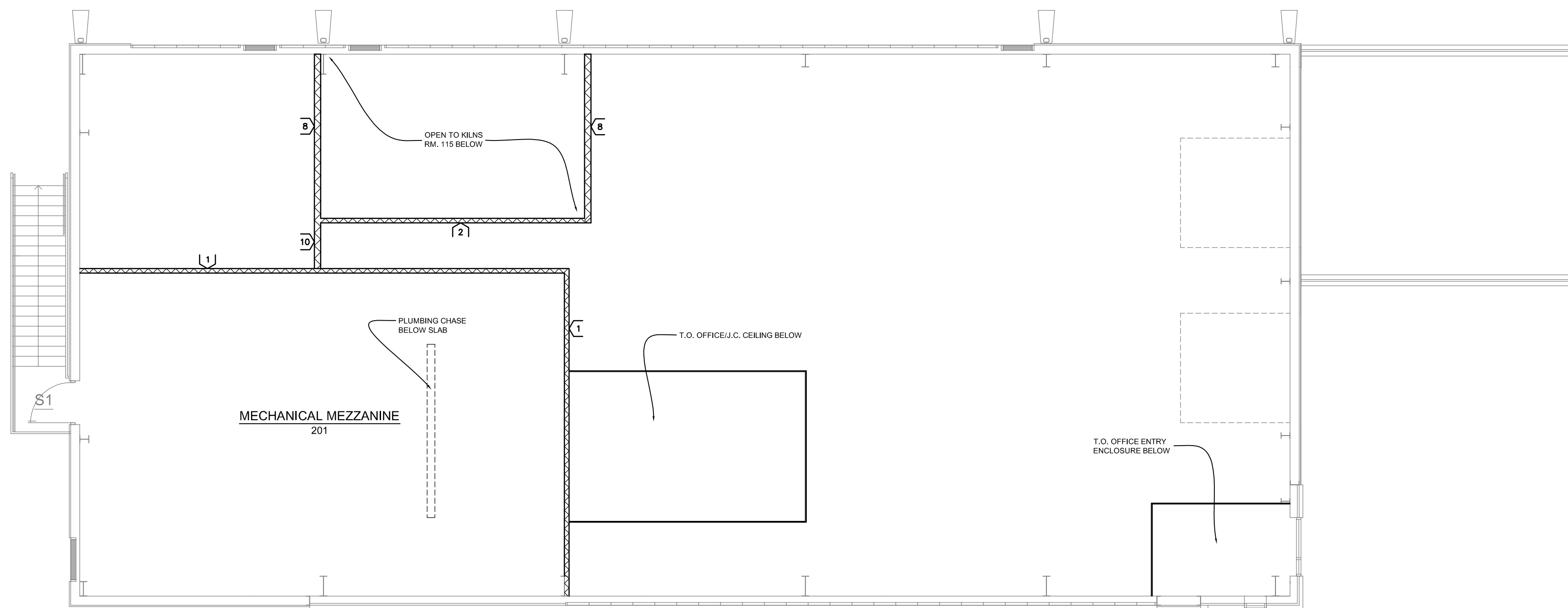

**2** Mechanical Level Floor Plan  
Scale: 1/8" = 1'-0"

**PARTITION TYPE SCHEDULE**

TYPE	SUPPORT	FACING	NOM THK.	HEIGHT	FIRE RATING	STC RATING	INSUL ACTION	SPECIAL REQTS	REMARKS
1	3 5/8" DRYWALL STUDS SPACED @ 16" O.C.	ONE LAYER OF 5/8" TYPE X GWB EACH SIDE	5"	TO STRUCTURAL DECK ABOVE	---	45-49	3" SOUND BLANKET	---	
2	3 5/8" DRYWALL STUDS SPACED @ 16" O.C.	ONE LAYER OF 5/8" TYPE X GWB EACH SIDE	5"	TO STRUCTURAL DECK ABOVE	---	---	---	---	
3	3 5/8" DRYWALL STUDS SPACED @ 16" O.C.	ONE LAYER OF 5/8" TYPE X GWB ON ROOM SIDE	4"	TO STRUCTURAL DECK ABOVE	---	45-49	3" SOUND BLANKET	---	
4	3 5/8" DRYWALL STUDS SPACED @ 16" O.C.	ONE LAYER OF 5/8" TYPE X GWB ON ROOM SIDE	4"	TO STRUCTURAL DECK ABOVE	---	---	---	---	
5	3 5/8" DRYWALL STUDS SPACED @ 16" O.C.	ONE LAYER OF 5/8" TYPE X GWB EACH SIDE	5"	UP TO 11'10"	1 HR	45-49	3" SOUND BLANKET	---	ROOM 104 IS REQUIRED TO BE 1 HR FIRE RATED IN FUTURE REMODEL.
6	3 5/8" DRYWALL STUDS SPACED @ 16" O.C.	ONE LAYER OF 5/8" TYPE X GWB EACH SIDE	5"	UP TO 11'10"	---	---	---	---	
7	4" DRYWALL STUDS SPACED @ 16" O.C.	ONE LAYER OF 5/8" TYPE X GWB ON EACH SIDE	7"	TO STRUCTURAL DECK ABOVE	---	45-49	3" SOUND BLANKET	---	
8	4" DRYWALL STUDS SPACED @ 16" O.C.	ONE LAYER OF 5/8" TYPE X GWB ON EACH SIDE	7"	TO STRUCTURAL DECK ABOVE	---	---	---	---	
9	4" DRYWALL STUDS SPACED @ 16" O.C.	ONE LAYER OF 5/8" TYPE X GWB ON EACH SIDE	7"	UP TO 11'10"	---	---	---	---	
10	4" DRYWALL STUDS SPACED @ 16" O.C.	ONE LAYER OF 5/8" TYPE X GWB ON EACH SIDE	7"	FROM 11'10" TO STRUCTURE	---	---	---	---	

NOTES:

**Door and Frame Schedule**

OPNG #	DOOR						FRAME		DETAILS		REMARKS			
	WIDTH	HEIGHT	THICKNESS	TYPE	FINISH	ELEVATION	LABEL	ELEVATION	MATERIAL	FINISH		HEAD	JAMB	THRESH
First Level														
199A	3'-4"	7'-0"	1 3/4"	HM-00	PANT	C	---	F-2	16 GA METL	SQE	D-11	D-9/D-10	---	HM-1
104A	3'-4"	7'-0"	1 3/4"	HM-60	PANT	B	60 MIN	F-1	16 GA METL	SQE	D-11	D-9/D-10	---	HM-3
106A	3'-0"	7'-0"	1 3/4"	HM-00	PANT	A	---	F-1	16 GA METL	SQE	D-11	D-9/D-10	---	HM-2
107A	3'-0"	7'-0"	1 3/4"	HM-00	PANT	A	---	F-1	16 GA METL	SQE	D-11	D-9/D-10	---	HM-5
108A	3'-0"	7'-0"	1 3/4"	HM-00	PANT	B	---	F-1	16 GA METL	SQE	D-11	D-9/D-10	---	HM-2
113A	3'-0"	7'-0"	1 3/4"	HM-00	PANT	B	---	F-1	16 GA METL	SQE	D-11	D-1/D-2	---	HM-3
115A	PR 3'-0"	7'-0"	1 3/4"	HM-00	PANT	A	---	F-1	16 GA METL	SQE	D-11	D-1/D-2	---	HM-6

NOTES:

- 1) "DOOR SIZE" REFERS TO HIDE OPENING SIZE OF CASING/OPENING.
- 2) ALL LOCKS TO BE KEVED TO "MASTER" (COORDINATE W/ OWNERS) - DOORS 106A AND 113A TO BE FITTED FOR FUTURE ACCESS CONTROL HARDWARE.
- 3) FIT OUT DOOR 104A FOR A FUTURE DOOR CLOSURE.
- 4) PREP DOOR 199A FOR A MORTISE CLASSROOM LOCK WITH ELECTRIC STRIKE.

**Door Type Schedule**

DOOR TYPES						
TYPE	CONSTRUCTION	THICKNESS	FACE MATERIAL	FIRE RATING	FINISH	SPECIAL REQTS
HM-00	HOLLOW METAL FLUSH DOOR	1 3/4"	18 GA. STEEL	---	PT	---
HM-60	HOLLOW METAL FLUSH DOOR	1 3/4"	18 GA. STEEL	60 MIN.	PT	---

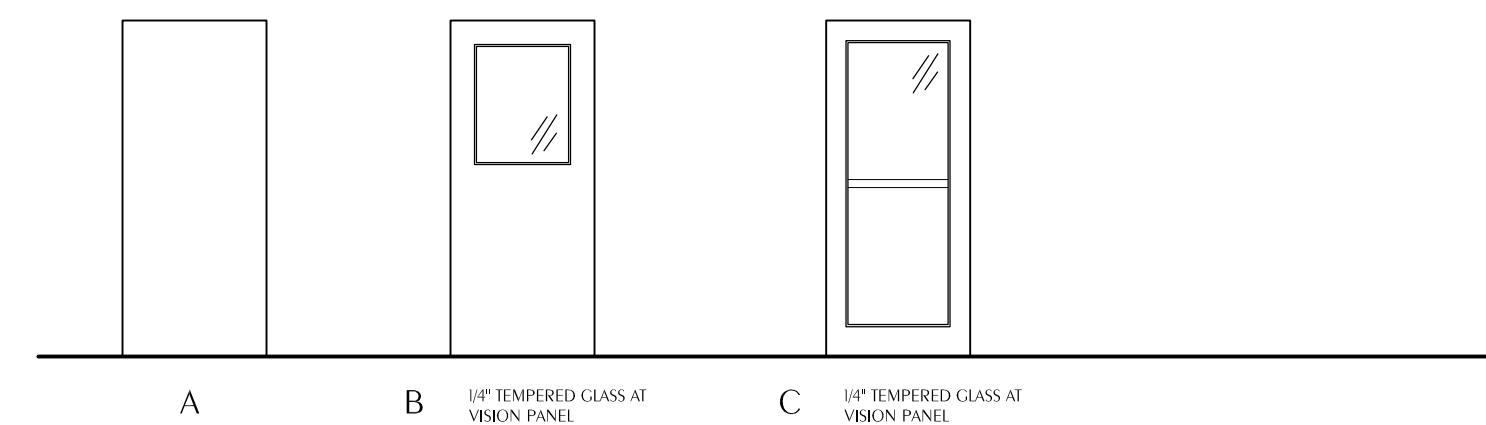

**Door Elevations**

SCALE: 1/4" = 1'

\*\*\*NOTE: ALL ELEVATIONS SHOWN FROM EXTERIOR SIDE UNLESS NOTED OTHERWISE.

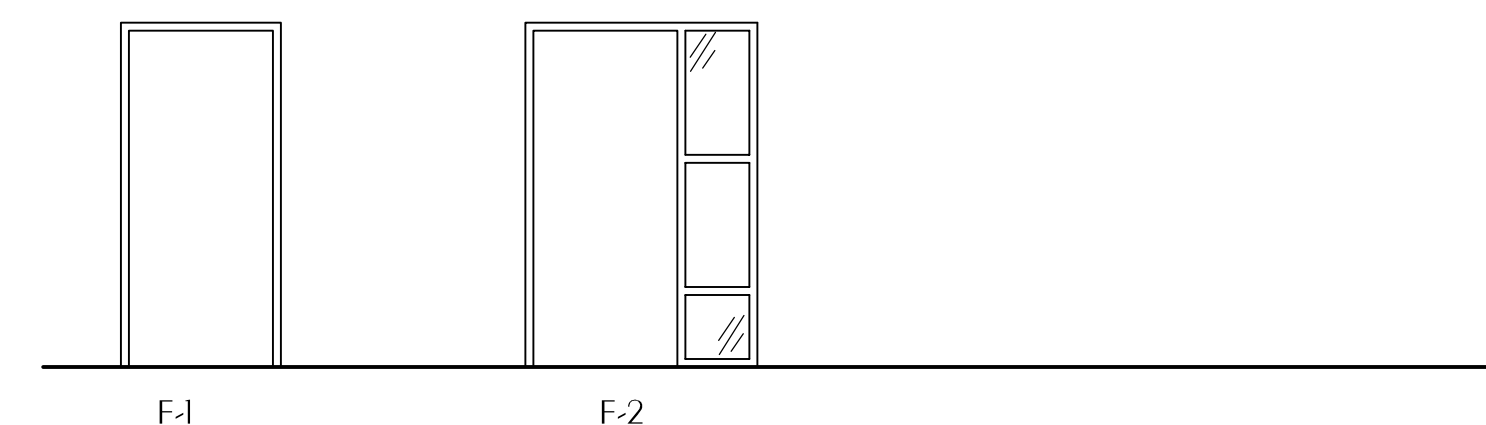

**Frame Elevations**

SCALE: 1/4" = 1'

\*\*\*NOTE: ALL ELEVATIONS SHOWN FROM EXTERIOR SIDE UNLESS NOTED OTHERWISE.

Lincoln  
1221 N Street, Suite 600  
Lincoln NE 68508  
Phone 402-476-9700  
Fax 402-476-9722

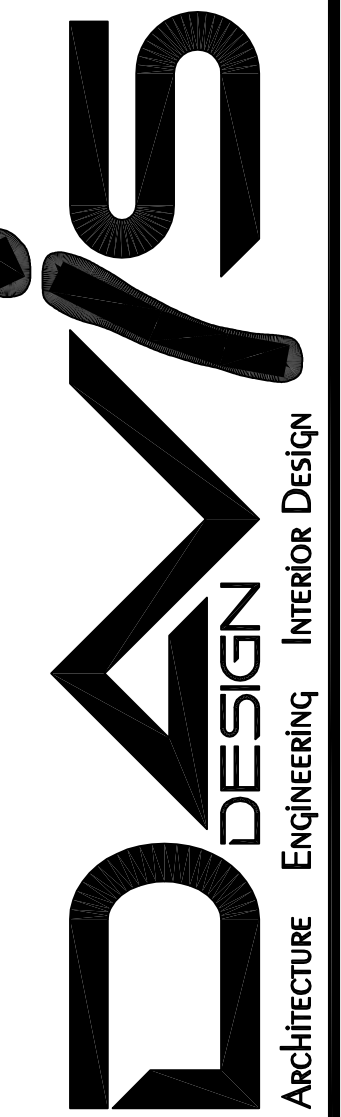

Preliminary  
not for  
Construction

CLIENT INFORMATION  
**SDSU**  
South Dakota  
State University

PROJECT INFORMATION  
**New Headhouse &  
Greenhouse -  
Interior Finish  
Package**

SDSU Job # 201202336  
Davis Design Job # 12-0124

ISSUE DATE: 02-07-2013  
Revisions:  
ID | Date | Description

CHECKED: lmm  
AUTHOR: jcs  
DAVIS DESIGN ALL RIGHTS RESERVED

SHEET TITLE  
**First Floor &  
Mechanical  
Level Plan w/  
Schedules**

SHEET NUMBER  
**A-101**