



Abbott ID Now COVID-19 Testing for South Dakota Public Universities and Technical Colleges



Types of SARS-CoV-2 Tests

- **Antibody Tests:**
 - Detect past SARS-CoV-2 infections
 - Antibody tests typically detect immunoglobulin proteins (IgM/IgG)
 - Not useful for identification of active infections
- **Diagnostic Tests:**
 - Detect active SARS-CoV-2 infections
 - Molecular (PCR) Tests: detect the genome of SARS-CoV-2
 - Antigen Tests: detect viral proteins

Categories of SARS-CoV-2 Diagnostic Tests

- **Non-Waived Tests:**
 - Moderate and high complexity tests
 - Point-of-care and laboratory-base
 - Moderate or high complexity laboratory certificate is required
- **Waived Tests:**
 - Relatively simple tests that are easy to use
 - Little to no chance the test will provide wrong information
 - CLIA Certificate of Waiver is required

CLIA Waived SARS-CoV-2 Diagnostic Tests

- **Antigen Tests:**

- BD Veritor
- Quidel Sofia 2



- **Molecular Tests:**

- Mesa Biotech Accula
- Abbott ID Now



To learn more about SARS-CoV-2 FDA-EUA approved tests, please consult the [FDA-EUA website](#).

Abbott ID Now: Quick Facts

- **Patient Population:** [symptomatic individuals](#)
- **Specimen Type:** upper respiratory; nasal swab
- **Specimen Collection Device:** swab; provided with each test
- **Time to Positive Result:** approximately 5 minutes
- **Time to Negative Result:** approximately 15 minutes
- **Test Cost:** \$43
- **Kit Cost:** \$1,032
- **Test Fee:** to be determined by facility/institution

Abbott: Points-of-Contact

- **Abbott will provide:**
 - Comprehensive training on the use of the Abbott ID Now instrument
 - Technical resources
 - [ID Now Performance, From Researchers in the Field](#)
 - [Steps to Use ID Now Effectively](#)
 - Account resources including options for test kit purchase

Holly Hunt, MLT (ASCP)

Technical Consultant
Abbott Rapid Diagnostics
30 S. Keller Road
Suite 100
Orlando, FL 32810
Customer Support 877-441-7440
holly.hunt@abbott.com

Amy Kilburg

Account Executive, POL
Abbott Rapid Diagnostics
CO, NE, SD
amy.kilburg@abbott.com

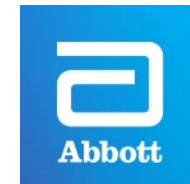

Abbott ID Now: Instrument and Materials



[Abbott ID Now Quick Reference Instructions](#)

Abbott ID Now: Instrument Use

1



Open the ID Now instrument lid.

2



Insert the orange test base.

Abbott ID Now: Instrument Use

3



Do not open the sample receiver before placing in the instrument.

15°C → 30°C



Insert the blue sample receiver.

4



Open the blue sample receiver and gently stir sample receiver buffer with patient swab.

Abbott ID Now: Instrument Use

5

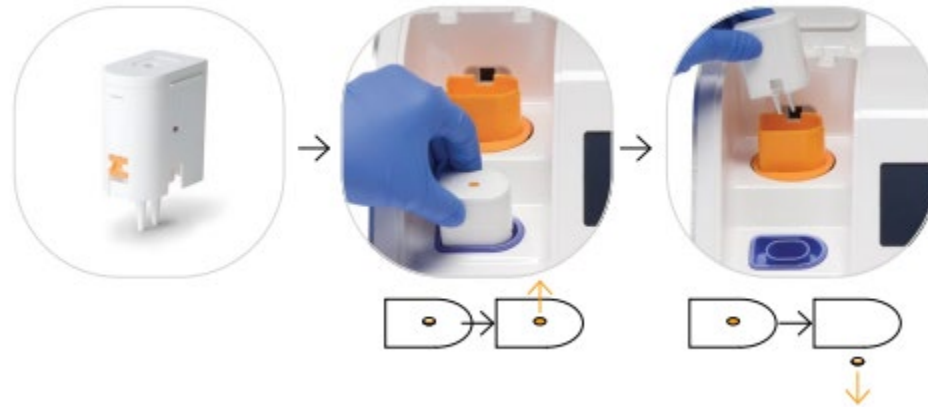

Insert transfer cartridge into blue sample receiver. Transfer white sample transfer cartridge to the orange test base.

6



Close the lid.

Abbott ID Now: Result Options

7

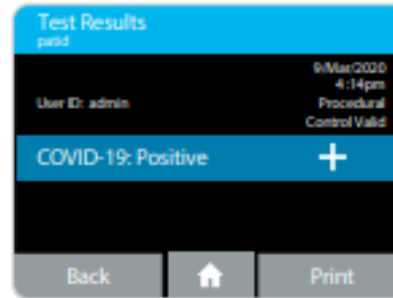

Refer to Product Insert instructions for retest procedure in the case of an **Invalid** result.

The ID Now will provide one of three results including: Positive, Negative, or Invalid.

Abbott ID Now: Waste Management

8



Remove the white sample transfer cartridge that is attached to the orange test base.



Insert into the blue sample receiver.



Discard entire assembly.

Q & A

How Many Instruments and Tests Will Each Institution Receive?

- SDDOH will distribute Abbott ID Now instruments and tests to South Dakota public universities and technical colleges based on [student enrollment](#) as follows:
 - <5,000 students: 1 instrument; 500 tests
 - 5,000-10,000 students: 2 instruments; 1,000 tests
 - >10,000 students: 3 instruments; 1,500 tests

Where Will DOH Place Abbott ID Now Instruments and Tests?

- Northern State University: Student Health Clinic
- Black Hills State University: Student Health Clinic
- South Dakota State University: Student Health Clinic
- South Dakota School of Mines & Technology: Student Health Clinic
- University of South Dakota: Student Health Clinic
- Dakota State University: Community Partner
- Western Dakota Technical College: Community Partner
- Mitchell Technical College: Community Partner
- Lake Area Technical College: Community Partner
- Southeast Technical College: Community Partner

SARS-CoV-2 Testing Support: Public Universities and Technical Schools

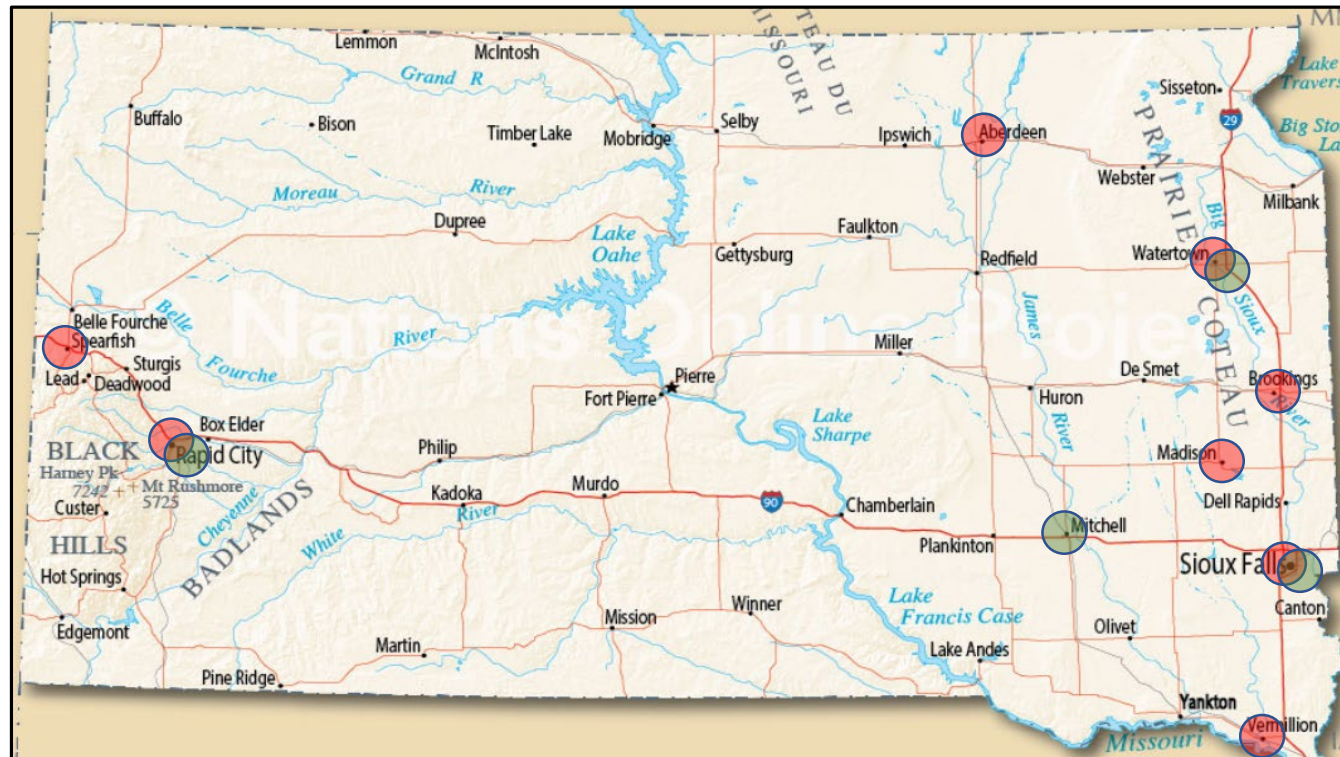

● Universities

● Technical Schools

- Black Hills State University
- SD School of Mines and Technology
- The University of South Dakota
- Dakota State University
- South Dakota State University
- Northern State University
- Mitchell Technical College
- Western Dakota Technical Institute
- Lake Area Technical Institute
- Southeast Technical Institute

When Will DOH Make These Instruments and Supplies Available?

- Shipments for institutions with student health programs will begin the week of August 3.
- Shipments for institutions that request placement of instrument(s) and supplies at a community-based clinic will begin August 10.
- All instruments and tests will be placed by August 14.

How Should Colleges and Universities Use the Abbott ID Now Test?

- **Appropriate use of Abbott ID Now resources:**
 - Routine diagnostic testing
 - Symptomatic individuals
 - Students, faculty, staff
- **Inappropriate use of Abbott ID Now resources:**
 - Asymptomatic individuals
 - Mass testing initiatives
 - “Screening” ahead of sporting events

How Are Abbott ID Now Results Reported to Patients?

- **Positive Results:**
 - Follow institution or facility policies and procedures for patient notification
 - Notify SDDOH of positive result to initiate investigation and contact tracing
- **Negative Results:**
 - Follow institution/facility policies and procedures for patient notification
 - If patient is symptomatic, recollect upper respiratory specimen for follow-up testing with local laboratory
- **Invalid Results:**
 - Follow Abbott ID Now recommendations for retesting specimen or specimen recollection

Do Abbott ID Now Test Results Have To Be Reported to the DOH?

- All positive, negative, and indeterminate SARS-CoV-2 test results must be reported to SD-DOH
- For facilities that have an electronic laboratory reporting (ELR) interface with SD-DOH, SARS-CoV-2 test results should be reported by ELR.
- For facilities that do not have ELR, report SARS-CoV-2 test results by one of the following methods:
 - [Secure website](#)
 - Fax 605.773.5509
 - Phone 605.773.3737 or 800.592.1861

Are Abbott ID Now Tests Available for Purchase?

- Abbott indicates that ID Now COVID-19 test kits will be available on the open market in September.
- Abbott ID Now COVID-19 kits are currently available by allocation from McKesson. Please contact McKesson at the following for additional details:

Matt Van Dam
McKesson Medical-Surgical
South Dakota / NW IA / SW MN
605-376-0090
Matt.VanDam@McKesson.com

How is Quality Control Performed?

- Positive and negative controls will be provided with each instrument.
- Control materials can be used for training, verification, and for quality control; Abbott will provide instructions for these procedures during training.
- Control materials can be used to reverify the instrument if the instrument is moved between locations.

What Does Peer Reviewed Literature Say About Abbott ID Now Performance?

[Basu et al, 2020](#). Journal of Clinical Microbiology. Performance of Abbott ID Now COVID-19 Rapid Nucleic Acid Amplification Test Using Nasopharyngeal Swabs Transported in Viral Transport Media and Dry Nasal Swabs in a New York City Academic Institution.

[Cradic et al, 2020](#). American Journal of Clinical Pathology. Clinical Evaluation and Utilization of Multiple Molecular In Vitro Diagnostic Assays for the Detection of SARS-CoV-2.

*Abbott ID Now test protocol changed from a specimen diluted in viral transport medium to dry swab testing.